



**Alcohol and Gaming Commission of Ontario**  
 90 Sheppard Avenue East  
 Suite 200  
 Toronto ON M2N 0A4  
 Telephone: 416 326-8700 or 1 800 522-2876 toll free in Ontario  
 Website: www.agco.ca

## Temporary Extension of Premises

### 1. Premises Information

Licence Number <i>44070</i>
--------------------------------

### 2. Contact Person

Contact Name <i>Marsha Ambeau</i>		Email [REDACTED]
Address [REDACTED]	City/ Town <i>Dunnville ON</i>	Postal Code [REDACTED]
Phone Number [REDACTED]	Contact Person's Relationship to the Licensed Premises <i>Associate member Event Chairperson</i>	Fax

### 3. Event Information

Event Name & Details		
List Dates	Start Time	End Time
<i>1. Sunday June 10/18</i>	<i>12:00 pm</i>	<i>6:00 pm</i>
<i>2.</i>		
<i>3.</i>		
<i>4.</i>		
<i>5.</i>		
<i>6.</i>		
<i>7.</i>		
<i>8.</i>		
<i>9.</i>		
<i>10.</i>		
<i>11.</i>		
<i>12.</i>		
<i>13.</i>		
<i>14.</i>		

**4. Extension Information**

<p>4.1 Is the proposed extension indoors?  If "Yes", please specify the location of proposed extension in relation to currently licensed area.</p>	<p><input type="checkbox"/> Yes <input checked="" type="checkbox"/> No</p>
<p>4.2 Is the proposed extension outdoors?  If "Yes", please specify the location of proposed extension in relation to currently licensed area. <i>Entire parking lot adjacent to 2 existing licensed areas.</i>  A Letter of Non-Objection from the municipal clerk will be required.  If the municipality owns the land, the Letter of Non-Objection can confirm the municipality (as owner) approves. Otherwise, a separate Letter of Non-Objection from the Municipal clerk must be submitted to confirm the municipality (as owner) approves. <i>Letter of Non Objection has been applied for. Council meeting May 22. Letter should be available May 23 if approved.</i></p>	<p><input checked="" type="checkbox"/> Yes <input type="checkbox"/> No</p>
<p>4.3 Location of Proposed Extension in relation to currently licensed area <i>Whole parking lot (connecting 2 existing areas)</i></p>	<p>4.4 Dimensions of Extension <i>4498 square feet</i></p>
<p>4.5 Maximum Capacity of Extension <i>374</i>  <b>Note:</b> to calculate "Capacity of Extension" use the following formula: Total area(length X width) divided by 1.11m or 12 ft. <i>Some area will be taken by band and food truck</i></p>	
<p>4.6 Does the licensee own the land of the proposed extended area?</p>	<p><input checked="" type="checkbox"/> Yes <input type="checkbox"/> No</p>
<p>4.7 Is the licensee renting/leasing the land of the proposed extended area?  If "Yes", a letter of approval from a landlord/owner to be attached</p>	<p><input type="checkbox"/> Yes <input checked="" type="checkbox"/> No</p>
<p>4.8 Does the municipality own the land of the proposed extended area?  If "Yes", A Letter of Non-Objection from the municipal clerk will be required  <b>Note:</b> If the event is also outdoors, then this Letter of Non-Objection can also confirm the municipality (as owner) approves. Otherwise, a separate Letter of Non-Objection from the municipal clerk must be submitted to confirm the municipality (as owner) approves.</p>	<p><input type="checkbox"/> Yes <input checked="" type="checkbox"/> No</p>
<p>4.9 Is there tiered seating in the proposed extension?  <b>Note:</b> A temporary tiered seating approval is required</p>	<p><input type="checkbox"/> Yes <input checked="" type="checkbox"/> No</p>

**5. Applicant Signature**

If the applicant is a sole proprietor, he/she must sign below.

If the applicant is a corporation, a person with authority to bind the corporation must sign below.

If the applicant is a partnership, all partners must sign below.

Print Name <i>Marsha Ambeau</i>	Signature <i>Marsha Ambeau</i>	Date YYYY MM DD <i>12/01/18 05/01</i>
Print Name	Signature	Date YYYY MM DD 
Print Name	Signature	Date YYYY MM DD 

**Notification**

The information you have submitted is collected pursuant to the *Liquor Licence Act*, R.S.O. 1990 Chapter L. 19 and/or the *Liquor Control Act*, R.S.O. 1990, Chapter L.18. The principal purpose of the collection is to determine eligibility for the issuance of a licence, permit and/or authorization or for an application made under the *Liquor Licence Act* and/or the *Liquor Control Act*. The information may also be disclosed pursuant to the *Freedom of Information and Protection of Privacy Act*, R.S.O. 1990, Chapter F. 31. For questions about the collection of this information, please contact Manager, Liquor Eligibility at: Alcohol and Gaming Commission of Ontario, 90 Sheppard Avenue East, Suite 200, Toronto, Ontario M2N 0A4 / Telephone: 416-326-8700 or 1-800-522-2876 (toll free in Ontario) / Email: [customer.service@agco.ca](mailto:customer.service@agco.ca)

# MAPLE STREET

## SIDEWALK

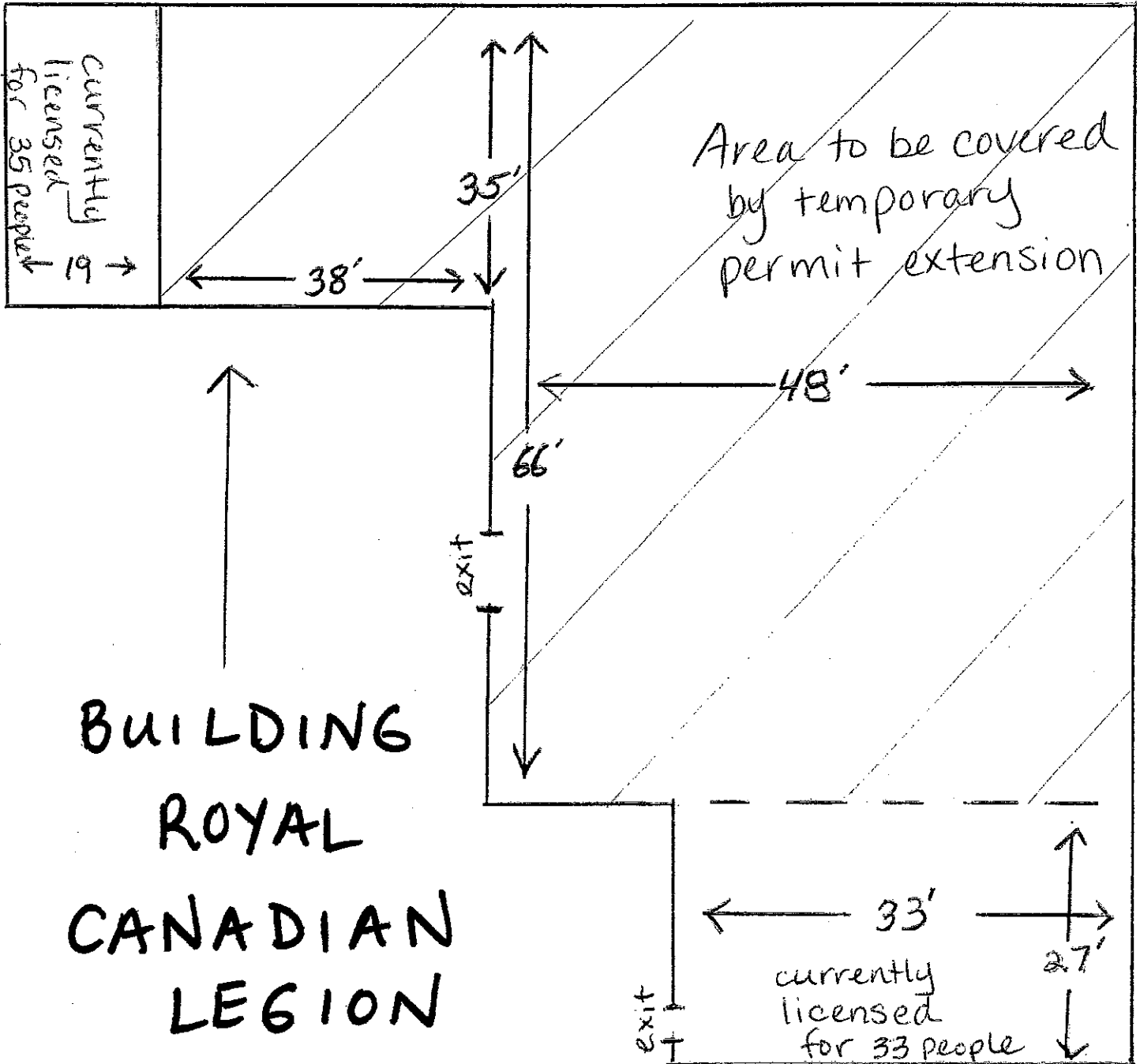

BUILDING  
ROYAL  
CANADIAN  
LEGION  
BRANCH 142