

Owner's Sketch 3 of 3 FILE #PLASGN-2025-103 APPLICANT: GEDSB & BHNCDSB

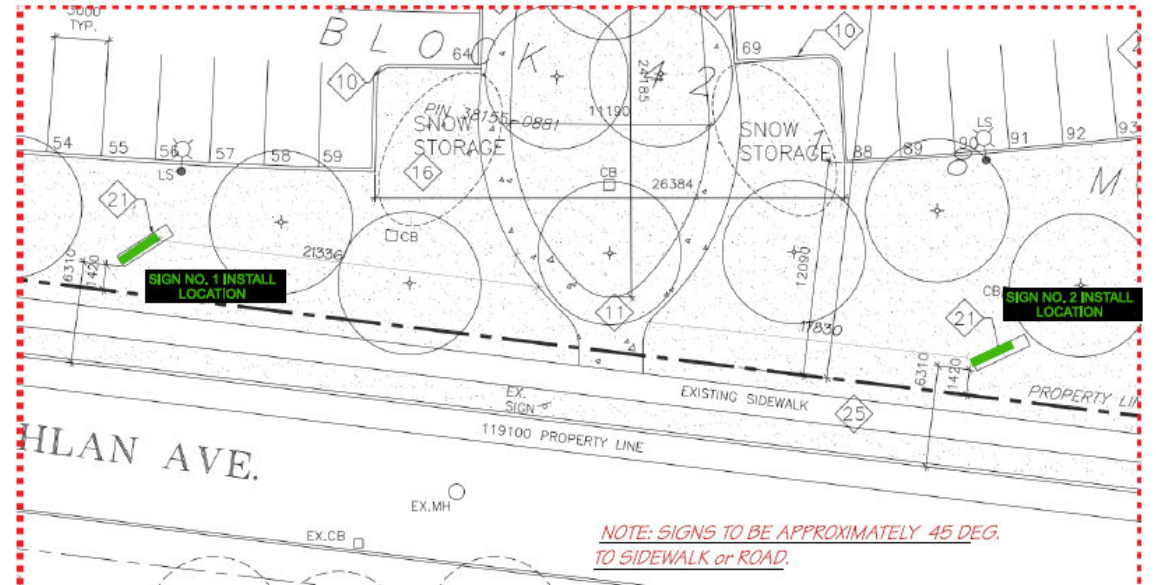
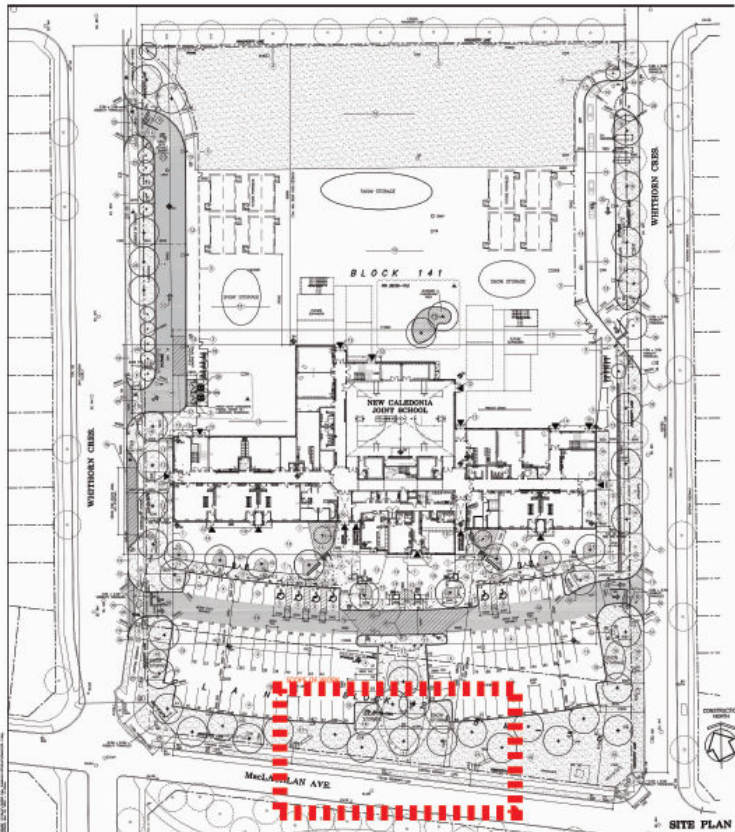

SIGN NO. 1 INSTALL LOCATION

NEW DOUBLE SIDED SIGN TO BE LOCATED:
6.31 M (20 FT.) FROM ROAD CURB (SOUTH) or
1.42 M (4'-6") FROM PROPERTY LINE (SOUTH).
AND 21.33 M (70 FT) FROM SIDEWALK (EAST)

SIGN NO. 2 INSTALL LOCATION

NEW DOUBLE SIDED SIGN TO BE LOCATED:
6.31 M (20 FT.) FROM ROAD CURB (SOUTH) or
1.42 M (4'-6") FROM PROPERTY LINE (SOUTH).
AND 17.83 M (58.5 FT) FROM SIDEWALK (WEST)

Gould Signs
Corporation

EXTERIOR SIGN SYSTEMS

1285 HUBREY RD., UNIT 5, LONDON, ON

519.681.1520 519.681.1522

PROJECT: SVEDAS ARCHITECTS INC.
LOCATION: RE: CALEDONIA SCHOOLS

REVISION DATE

DETAILS:

* INSTALL LOCATIONS FOR TWO NEW DOUBLE SIDED ILLUMINATED SIGNS.

ILLUMINATED SIGN DESIGN TO COMPLY WITH
ILLUMINATION DETAILS IN SECTION 4.3 CITY OF
LONDON SIGN BYLAW S.-5868-183 MAY 30 2017

DATE:
APRIL 29/25

FOLDER:
SVEDAS-ARCH

DRAWING #:
C25-036

APPROVED BY:
FOR PRODUCTION

gould@bellnet.ca

gouldsignscorp.com

SERVICE & INSTALLATION

3M Authorized Manufacturer
Commercial Graphics

OUTDOOR L.E.D.
MESSAGE DISPLAYS

UL LISTED

This artwork is copyrighted and owned by Gould Signs Corporation. This work may not be produced in whole or in part in any material form nor may any other use inconsistent with the copyright be made of the work.