

# Location Map FILE #PLB-2024-244 APPLICANT: Villam LTD/Clark Poultry Farm



**Location:**  
**394 4TH LINE**  
**GEOGRAPHIC TOWNSHIP OF ONEIDA**  
**WARD 4**

**Legal Description:**  
**OND CON 4 PT LOT 14**

**Property Assessment Number:**  
**2810 153 003 03200 0000**

**Size:**  
**Approx. 40.86 HECTARES**

**Zoning:**  
**A (Agriculture), GRCA (Regulated Lands)**  
**HCOP (Natural Environment Wetland Area)**  
**GRCA (Wetland)**

HALDIMAND COUNTY, ITS EMPLOYEES, OFFICERS AND AGENTS ARE NOT RESPONSIBLE FOR ANY ERRORS, OMISSIONS OR INACCURACIES WHETHER DUE TO THEIR OWN NEGLIGENCE OR OTHERWISE. DO NOT USE FOR OPERATING MAP OR DESIGN PURPOSES. ALL INFORMATION TO BE VERIFIED.

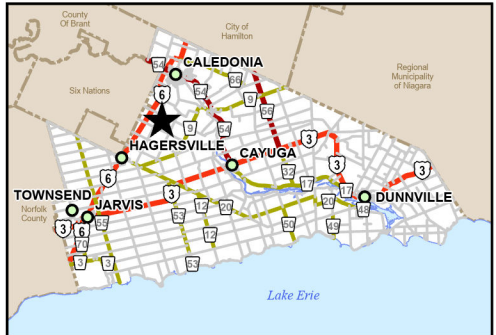
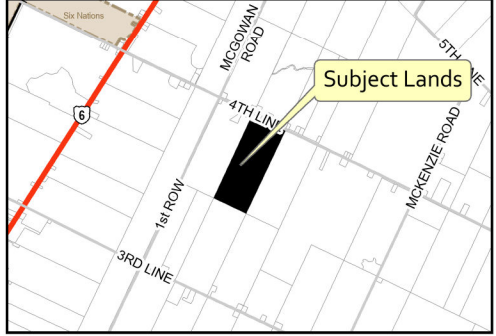

IMAGE INCLUDES MATERIAL ©2020 OF THE QUEEN'S PRINTER FOR ONTARIO, ALL RIGHTS RESERVED.