

# Location Map FILE #PLZ-HA-2021-207 APPLICANT: Lang

PDD-10-2022, Attachment 1



Detail 'A'

## Location:

**650 5TH LINE  
GEOGRAPHIC TOWNSHIP OF ONEIDA  
WARD 4**

## Legal Description:

**OND CON 5 PT LOTS 19**

## Property Assessment Number:

**2810 153 003 07600 0000**

## Size:

**98.36 Acres**

## Zoning:

**A (Agricultural)  
HL (GRCA Regulated Hazard Lands)**

HALDIMAND COUNTY, ITS EMPLOYEES, OFFICERS AND AGENTS ARE NOT RESPONSIBLE FOR ANY ERRORS, OMISSIONS OR INACCURACIES WHETHER DUE TO THEIR OWN NEGLIGENCE OR OTHERWISE. DO NOT USE FOR OPERATING MAP OR DESIGN PURPOSES. ALL INFORMATION TO BE VERIFIED.

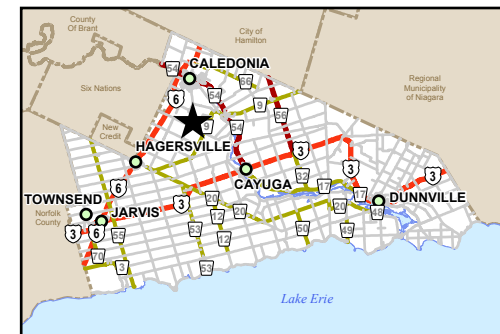
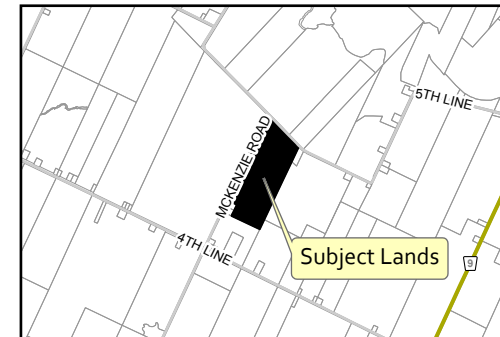

IMAGE INCLUDES MATERIAL © 2015 OF THE QUEEN'S PRINTER FOR ONTARIO. ALL RIGHTS RESERVED.