

Road Closure and Conveyance of Part of Lakeshore Road, Dunnville

LSS-02-2021, Attachment 2



Haldimand County

Legend

-  Provincial Highway
 Haldimand Highway
 Haldimand Road
 Local Road
 Settlement Areas

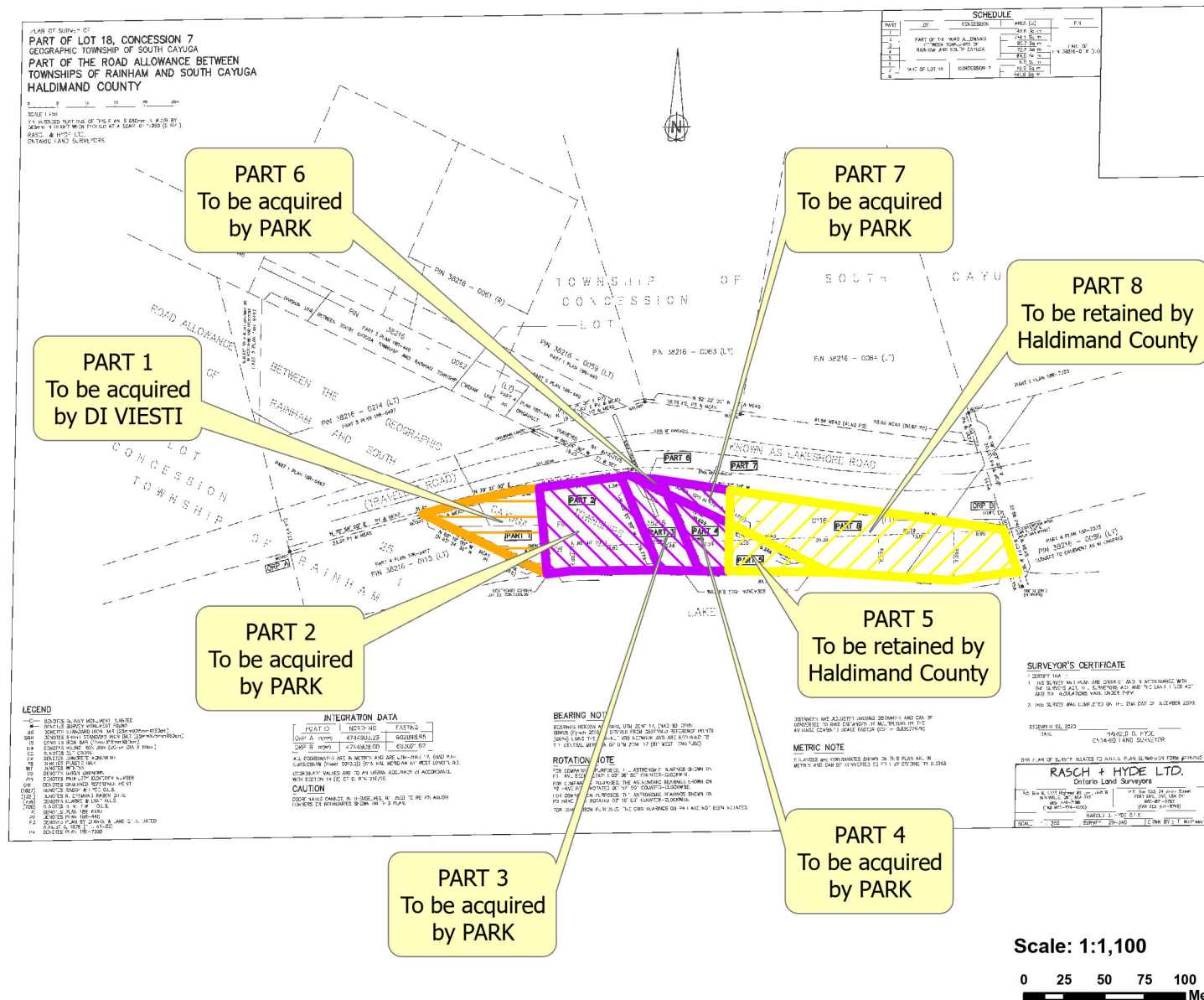

Location:

PART OF LOT 18, CONCESSION 7
GEOGRAPHIC TOWNSHIP OF SOUTH CAYUGA
PART OF ROAD ALLOWANCE BETWEEN
TOWNSHIPS OF RAINHAM AND SOUTH
CAYUGA
WARD 2

HALDIMAND COUNTY, IT'S EMPLOYEES, OFFICERS AND AGENTS ARE NOT RESPONSIBLE FOR ANY ERRORS, OMISSIONS OR INACCURACIES WHETHER DUE TO THEIR OWN NEGLIGENCE OR OTHERWISE. DO NOT USE FOR OPERATING MAP OR DESIGN PURPOSES.
ALL INFORMATION TO BE VERIFIED.

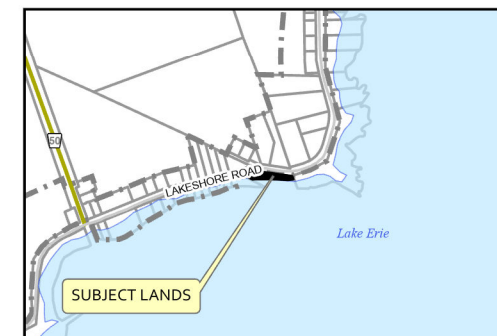

Scale: 1:1.100

