

Site Plan Map - Telecommunication Tower - 60 Little Road

PDD-23-2020, Attachment 2

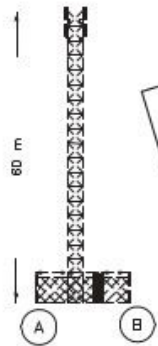

Haldimand County
ELEVATION PLAN
NOT TO SCALE



PROPOSED COMPOUND
LAYOUT PLAN
NOT TO SCALE

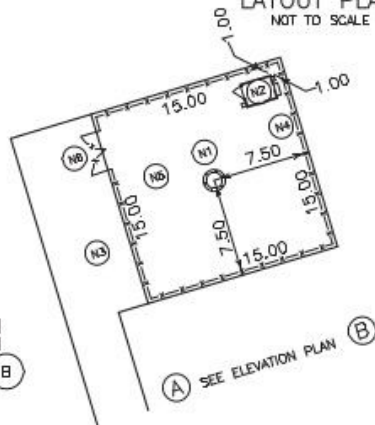

NOTES

- (N1) PROPOSED LATTICE TRI-POLE. PAINT COLOUR SUBJECT TO NAV CANADA REQUIREMENTS. ANTENNA NUMBER AND LOCATIONS TO BE DETERMINED. FOUNDATION DESIGN PENDING SOIL REPORT.
- (N2) PROPOSED RADIO EQUIPMENT SHELTER ON REINFORCED CONCRETE SLAB.
- (N3) PROPOSED ACCESS WAY AND HYDRO/FIBER OPTIC CONNECTION.
- (N4) PROPOSED 2.4 m HIGH CHAIN LINK SECURITY FENCE TOPPED WITH BARBED WIRE SURROUNDING THE COMPOUND.
- (N5) REMOVE EXISTING TOPSOIL, PROOF ROLL SUBGRADE AND PLACE 300 mm GRANULAR A ACROSS COMPOUND AREA. FINISHED GRAVEL SURFACE TO BE MINIMUM 150 mm ABOVE EXISTING GRADE AND SLOPED AWAY FROM PROPOSED STRUCTURES AT MIN. 1% ON ALL SIDES TO PROVIDE ADEQUATE DRAINAGE.
- (N6) PROPOSED CHAIN LINK GATE.

SKETCH SHOWING PROPOSED
BELL COMPOUND LOCATION

NOT TO SCALE

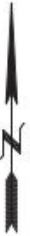

NOTE

THIS IS NOT A SURVEY.
NO LAND REGISTRY OFFICE SEARCH
WAS PERFORMED.
NO FIELD MEASUREMENTS WERE PERFORMED.
NO EASEMENTS AND RIGHT OF WAY CHECKS
WERE PERFORMED.

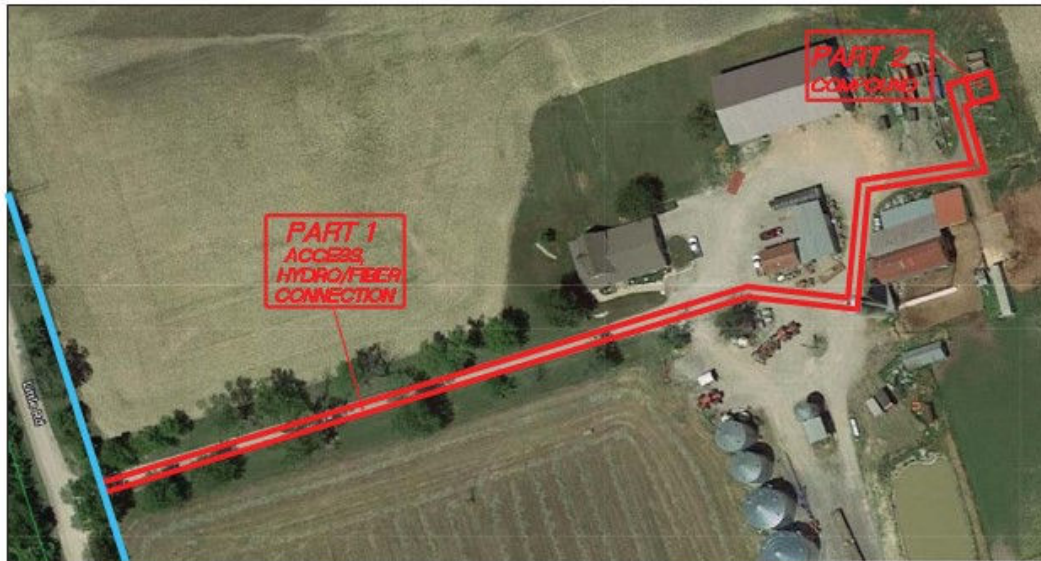

AMENDMENTS

No.	DESCRIPTION	DATE

APPROXIMATE LOCATION
OF PROPOSED TOWER
LATITUDE N42°54'40.5"
42.911250
LONGITUDE W79°53'41.2"
-79.894778

SITE: W3291

BELL