

**INTRODUCTION**

This letter of opinion accompanies an application for exemption from By-law 15-00 on behalf of the proponents George and Ann Lunshof relating to the property located at 1610 Highway 3 East in Dunnville ON, Haldimand County (Figure 1 & 2). It is prepared by Leonard + Associates in Landscape Architecture, whose principal has decades of experience with the landscape surrounding the subject property.

The legal parcel is 61.9 acres located south of Highway 3 East and north of Jenny Jump Road. The site is primarily active farmland, with a house along Highway 3 E, and Woodland/Wetland features at the south end, just north of Jenny Jump Road. Part of this land has been subject to prior litigation with respect to tree removal.

The client wants to remove vegetation to improve their agricultural land management best practices at the south end of the site. See Figure 2.

The proposed tree removal is prohibited by the Regional Municipality of Haldimand-Norfolk By-Law No. 15-00, unless the requested exemption is approved by the municipality. Haldimand County Forester, Adam Chamberlin, has requested a Terms of Reference (TOR) and Environmental Impact Study (EIS) be completed for the removal of what he characterized as four patches of woodland.

**SITE ALTERATION DESCRIPTION**

These four patches are shown on Figure 3 as Units A-D. These are respectively 0.53 ha, 0.25 ha, 0.08 ha, and 0.36 ha in size for a combined 1.22 hectares of proposed vegetation removal. These were delineated by Adam Chamberlin (Forester, Haldimand County). At one point all four patches were continuous. All of these have been disturbed over the years for a number of reasons including the removal of many dead Ash trees.

**NATURAL HERITAGE ATTRIBUTES**

The vegetation on-site is part of a larger continuum of woodland and wetlands. These four units are adjacent to wetlands to the east, south, and west, according to the MNR Natural Heritage Mapping. The vegetation on-site is not noted in the Natural Areas Inventory of the Regional Municipality of Haldimand-Norfolk 1987 publication; it is within 1 km of the Dunnville East Forest Tracts.

Patches C and D are separated from an unevaluated wetland community to the south and east by a drain and laneway. Directly west of Patch C is an evaluated Provincially Significant Wetland that is part of the Dunnville Woodlots East Wetland Complex. All Patches are within 120 m of this wetland boundary.

The vegetation patches illustrated on Figure 3 (Appendix 1). They are A\_ SWD6-2 Silver Maple Organic Deciduous Swamp Type (0.53 ha), B\_ SWD6-2 Silver Maple Organic Deciduous Swamp Type (0.25 ha), C\_ SWD6-2 Silver Maple Organic Deciduous Swamp Type (0.076 ha), and D\_ FOD7 Fresh Moist Lowland Deciduous Forest Ecosite (0.36 ha).

Direct impacts of the proposed exemption include both vegetation and habitat removal. However, these patches represent less than one percent of one percent of an extensive vegetative tract extending from the Grand River marshes at Dunnville to the Wainfleet Bog.

**CONCLUSION**

In our opinion, the elimination of these minuscule parcels of vegetation theoretically would have no impact on the larger tract of biomass referred to previously. During our two site visits that opinion has been confirmed.

Mike Leonard O.A.L.A. C.S.L.A.  
Paige Vroom MSc.



**APPENDIX 1: FIGURES**

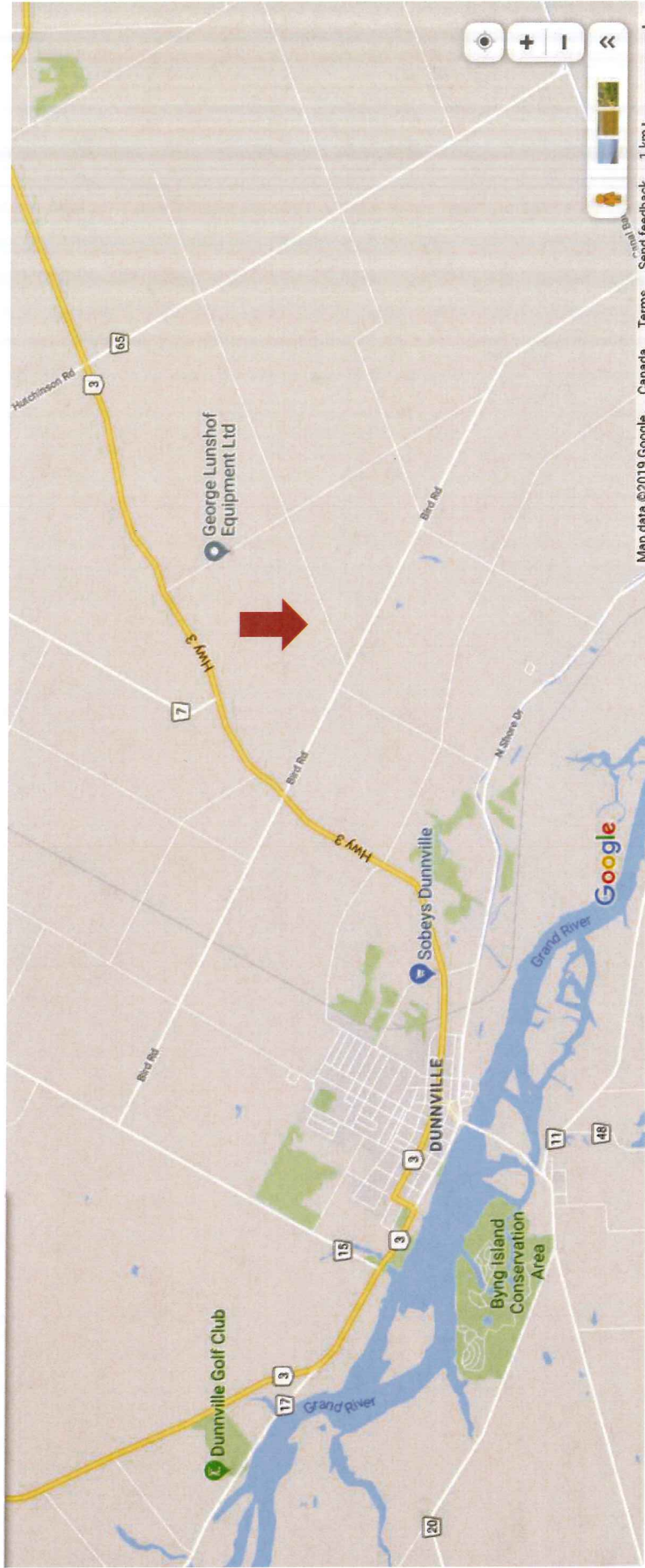

**Figure 1: General Site Location**



**Lunshof Scoped EIS Letter of Opinion October 2019**  
Leonard + Associates in Landscape Architecture



Figure 2: Specific Site Location

Red=Legal Parcel

Yellow= Area of Interest



Lunshof Scoped EIS Letter of Opinion October 2019  
Leonard + Associates in Landscape Architecture



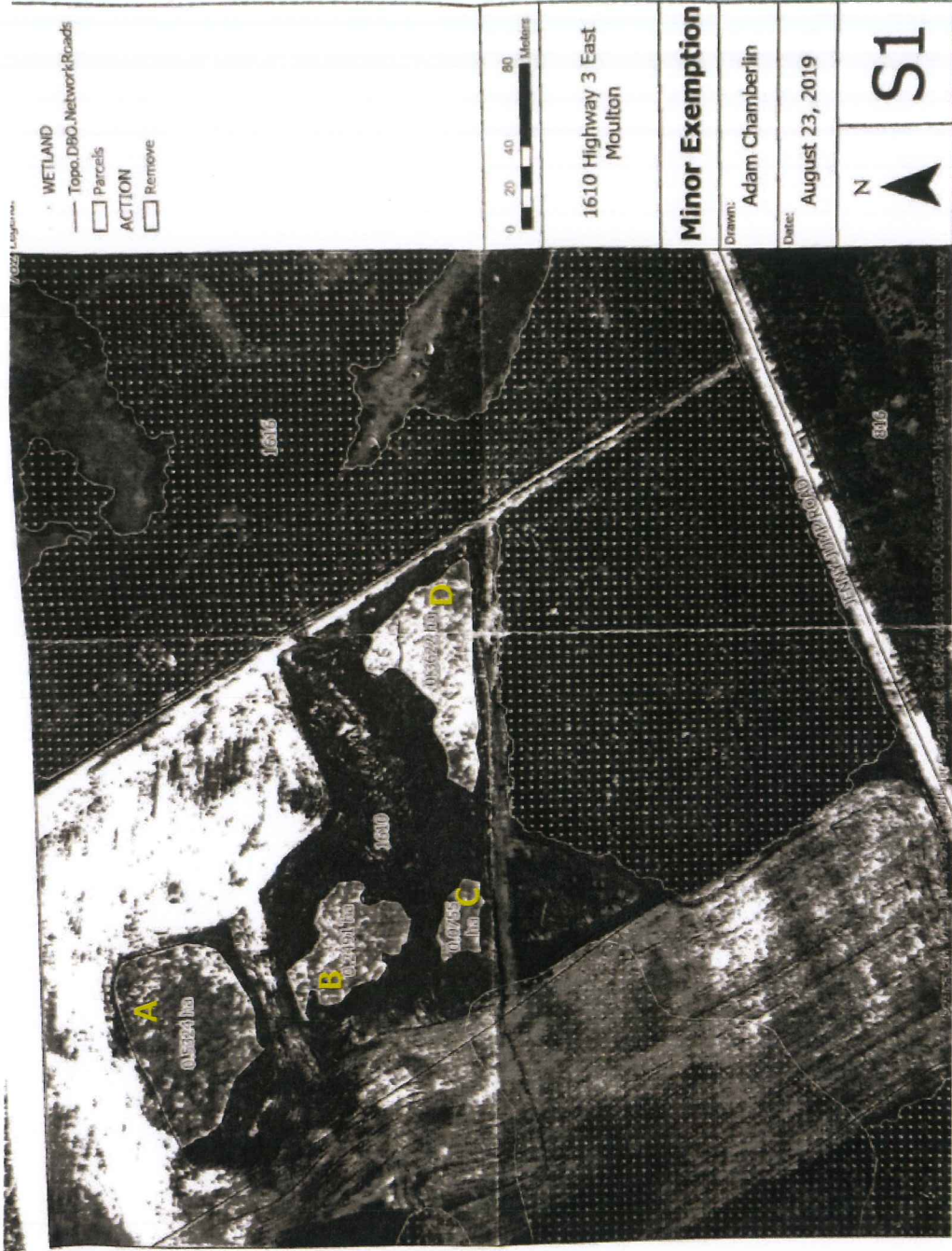

**Figure 3: Woodland Patches and ELC communities**  
 A\_ SWD6-2 Silver Maple Organic Deciduous Swamp Type  
 B\_ SWD6-2 Silver Maple Organic Deciduous Swamp Type  
 C\_ SWD6-2 Silver Maple Organic Deciduous Swamp Type  
 D\_ FOD7 Fresh Moist Lowland Deciduous Forest Ecosite



**Lunshof Scoped EIS Letter of Opinion October 2019**  
 Leonard + Associates in Landscape Architecture