

# Location Map FILE # PLZ-HA-2018-111 APPLICANT: Hamel

PED-PD-34-2018, Attachment 1



## Location:

**2695 NORTH SHORE DRIVE  
GEOGRAPHIC TOWNSHIP OF  
MOULTON, WARD 5**

## Legal Description:

**MOULTON CON 1 LE PT LOT 6 RP  
18R5973 PARTS 1 AND 2**

## Property Assessment Number:

**2810 023 003 13800 0000**

## Size:

**0.84 Acres**

## Zoning:

**CHA (Hamlet Commercial Zone)  
& RH (Hamlet Residential)**

HALDIMAND COUNTY, ITS EMPLOYEES, OFFICERS AND AGENTS ARE NOT RESPONSIBLE FOR ANY ERRORS, OMISSIONS OR INACCURACIES WHETHER DUE TO THEIR OWN NEGLIGENCE OR OTHERWISE. DO NOT USE FOR OPERATING MAP OR DESIGN PURPOSES. ALL INFORMATION TO BE VERIFIED.

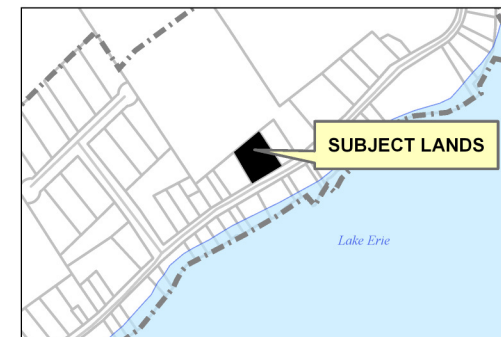

IMAGE INCLUDES MATERIAL © 2015 OF THE QUEEN'S PRINTER FOR ONTARIO. ALL RIGHTS RESERVED