

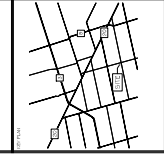

MSE ENGINEERING

1333 HIGHWAY #3
DANMARK, ONTARIO
N3A 3K7
PHONE: (905) 774-4327
FAX: (905) 774-1145

THE DRAWINGS AND SPECIFICATIONS
ARE PREPARED BY THE ENGINEER
TO BE USED ONLY FOR THE PROJECT
FOR WHICH THEY WERE ISSUED.
COPYRIGHT © 2018



THIS DRAINAGE PLAN IS BASED
ON SURVEY INFORMATION
PROVIDED BY:
RACH & HIGLE LTD.
ON 10/10/2018
P.O. BOX 6, 1333 HIGHWAY #3
EAST, UNIT B
DANMARK, ONTARIO
TEL: (905) 774-7169
SURVEY NO. 17-264

FITNESS AREA	
1. LOCATION	1333 HIGHWAY #3, DANMARK, ONTARIO
2. DATE	FEB 2018
3. DRAWN BY	MS
4. PURPOSE OF DRAW	PROPOSED

FISHERVILLE LIONS CLUB
WALKING TRACK
1/8 MAIN ST. W. CONC. 5' RD
FISHERVILLE ON
CAN. 1G0

PROPOSED
FITNESS
EQUIPMENT AREA

22-17-436

C-2

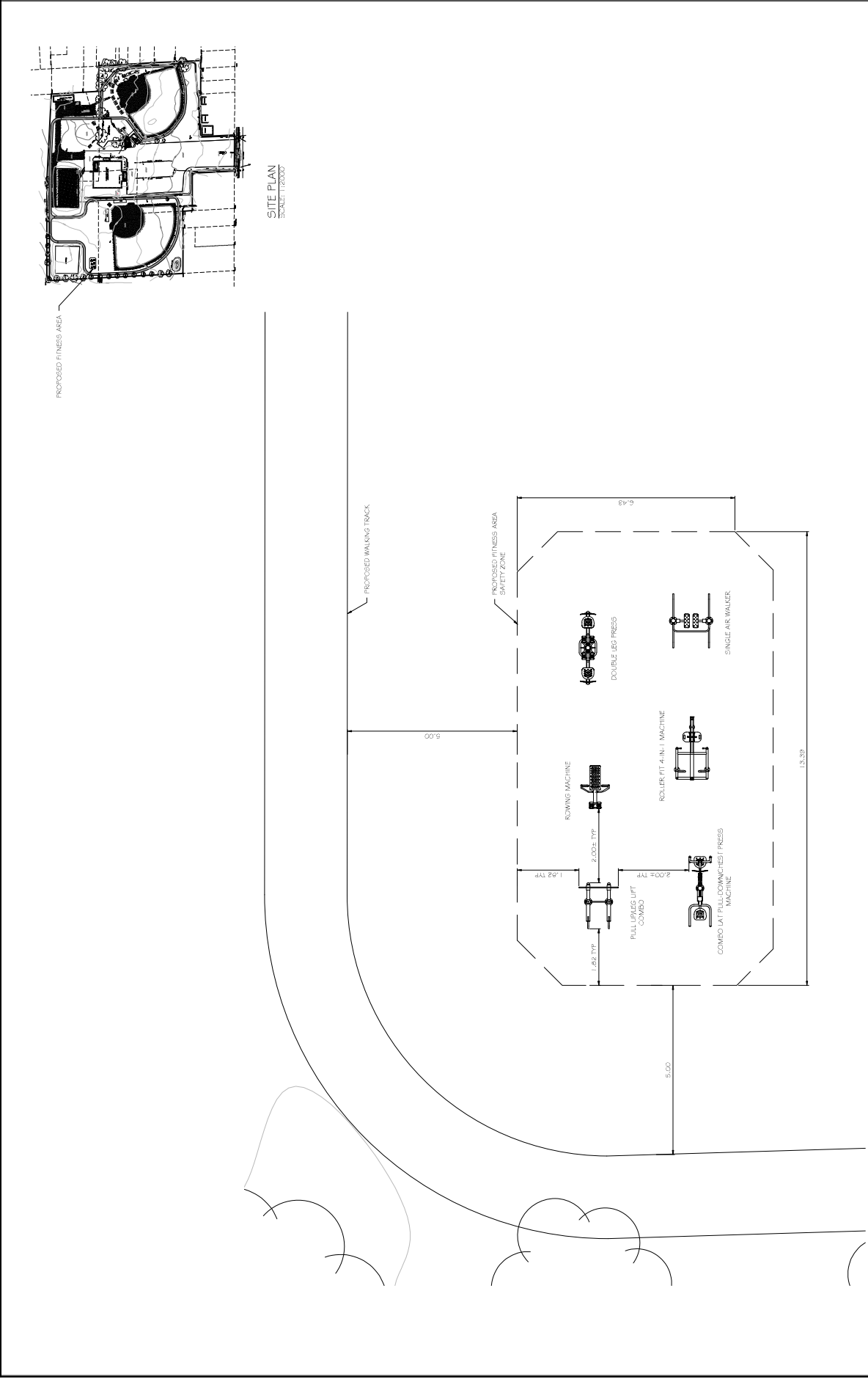

PROPOSED FITNESS AREA
SCALE: 1:50

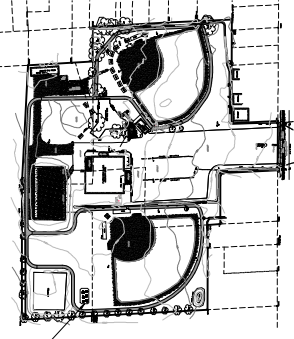

SITE PLAN
SCALE: 1:2000